



# metecno panel<sup>®</sup>

## Contents

---

Panel Details - PIR-W-01-5.....	3
Wall to Girt Fixing Detail - PIR07-OW01-1 .....	4
External Wall Base Detail - PIR07-OW03-1 .....	5
External Wall to Sheet Roof Joint - PIR07-OW04-1 .....	6
Base Detail - PIR07-WF01-1 .....	7

**Note:**

- We recommend that you should engage your local Metecno PIR® architectural specialist at design stage to ensure the panel system is designed to suit specific project requirements.
- All exposed core material is to be encapsulated with a non-combustible covering in order to achieve a BAL-40 or less.
- Panel by Metecno PIR®, screw may be by Metecno PIR®, all other items by others.
- Additional construction details are available through the Metecno PIR Website Client Portal or by contacting a local Metecno PIR® representative. [www.metecnopir.com.au](http://www.metecnopir.com.au)
- This drawing is copyright and the property of Metecno Pty Limited trading as Metecno PIR®. It is subject to their legal recall and may not be reproduced or it's contents divulged without written authority.

## Panel Details - PIR-W-01-5

### External Cladding



### FLAT FINISH

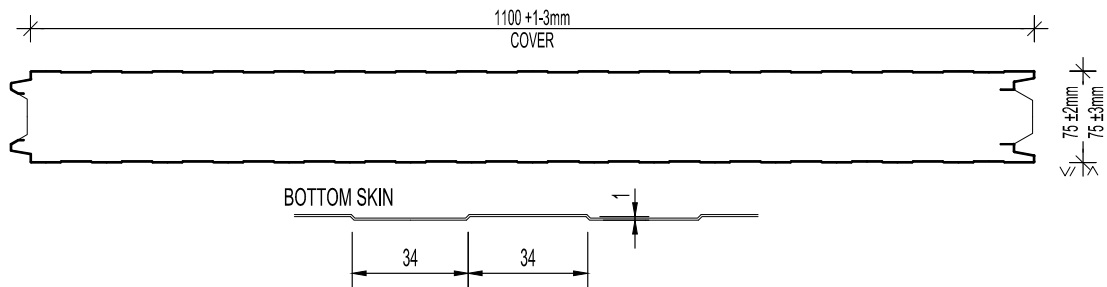

### FINELINE FINISH

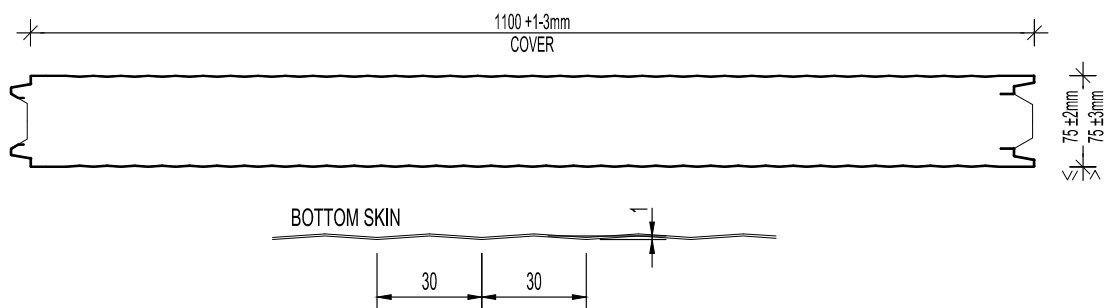

### SATILINE FINISH

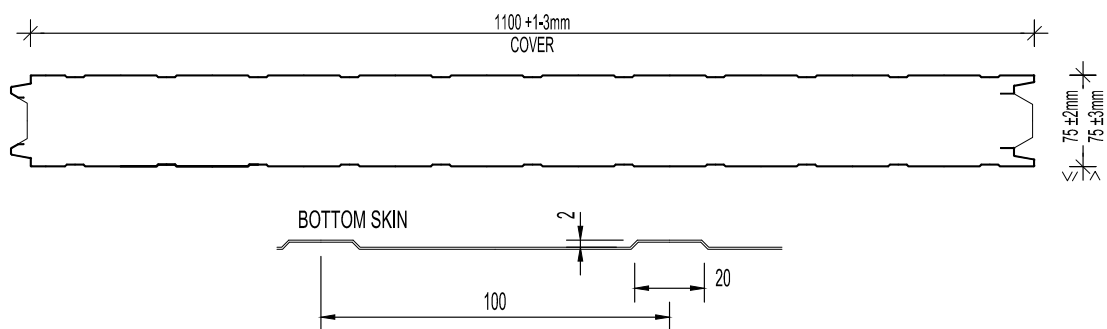

### STANDARD RIB FINISH

Note:

- We recommend that you should engage your local Metecno PIR<sup>®</sup> architectural specialist at design stage to ensure the panel system is designed to suit specific project requirements.
- All exposed core material is to be encapsulated with a non-combustible covering in order to achieve a BAL-40 or less.
- Panel by Metecno PIR<sup>®</sup>, screw may be by Metecno PIR<sup>®</sup>, all other items by others.
- Additional construction details are available through the Metecno PIR Website Client Portal or by contacting a local Metecno PIR<sup>®</sup> representative. [www.metecnopir.com.au](http://www.metecnopir.com.au)
- This drawing is copyright and the property of Metecno Pty Limited trading as Metecno PIR<sup>®</sup>. It is subject to their legal recall and may not be reproduced or its contents divulged without written authority.

## Wall to Girt Fixing Detail - PIR07-OW01-1

### External Vertical Cladding

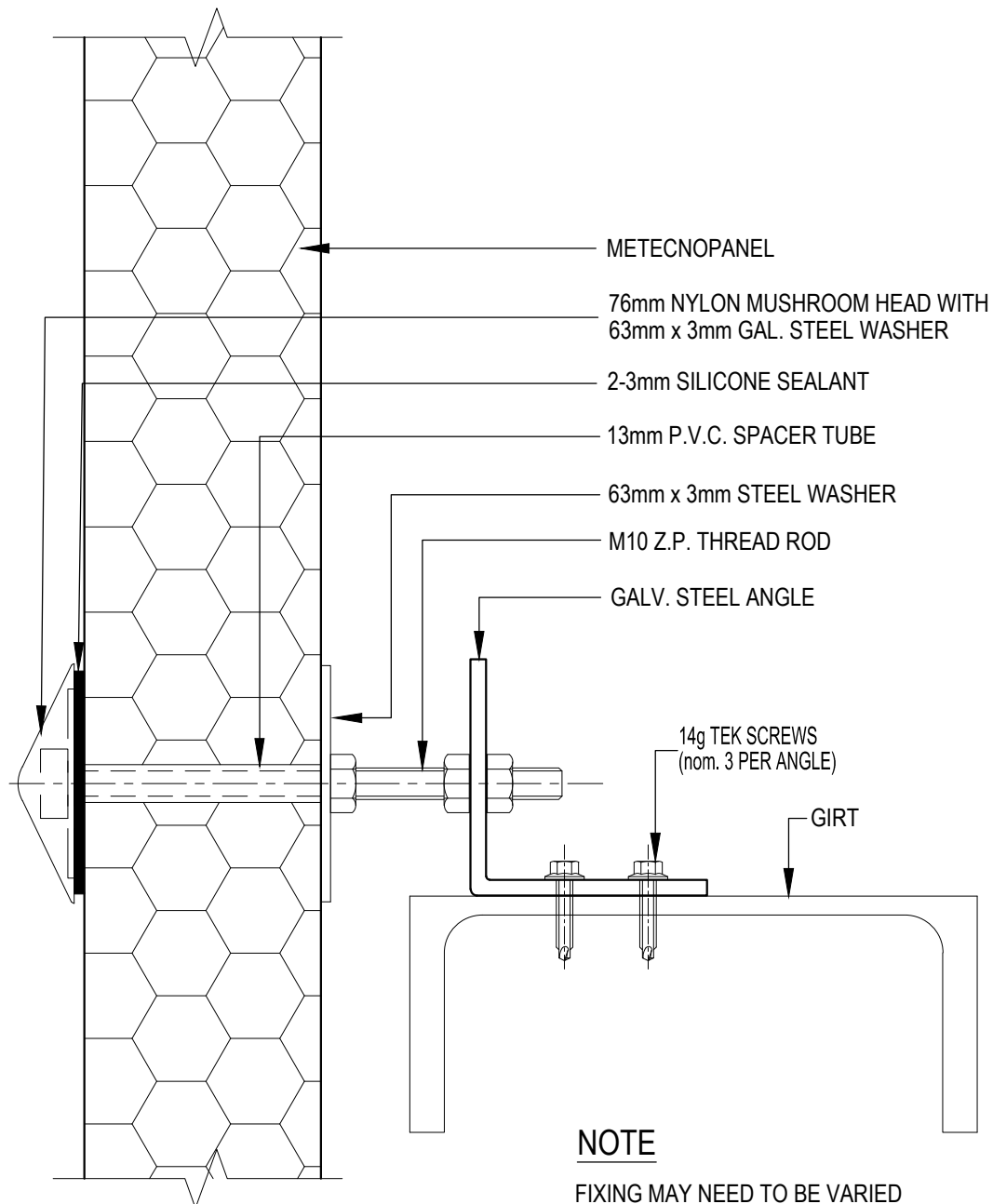

### NOTE

FIXING MAY NEED TO BE VARIED TO ALLOW FOR THERMAL BOW OF WALL PANEL IN SOME CASES

NUMBER OF GIRT FIXING PER PANEL VARIES WITH WIND LOADS REFER TO ENGINEER

SEALANTS ARE REQUIRED IN SOME APPLICATIONS BUT ARE NOT SHOWN

#### Note:

- We recommend that you should engage your local Metecno PIR<sup>®</sup> architectural specialist at design stage to ensure the panel system is designed to suit specific project requirements.
- All exposed core material is to be encapsulated with a non-combustible covering in order to achieve a BAL-40 or less.
- Panel by Metecno PIR<sup>®</sup>, screw may be by Metecno PIR<sup>®</sup>, all other items by others.
- Additional construction details are available through the Metecno PIR Website Client Portal or by contacting a local Metecno PIR<sup>®</sup> representative. [www.metecnopir.com.au](http://www.metecnopir.com.au)
- This drawing is copyright and the property of Metecno Pty Limited trading as Metecno PIR<sup>®</sup>. It is subject to their legal recall and may not be reproduced or its contents divulged without written authority.

## External Wall Base Detail - PIR07-OW03-1

### External Vertical Cladding

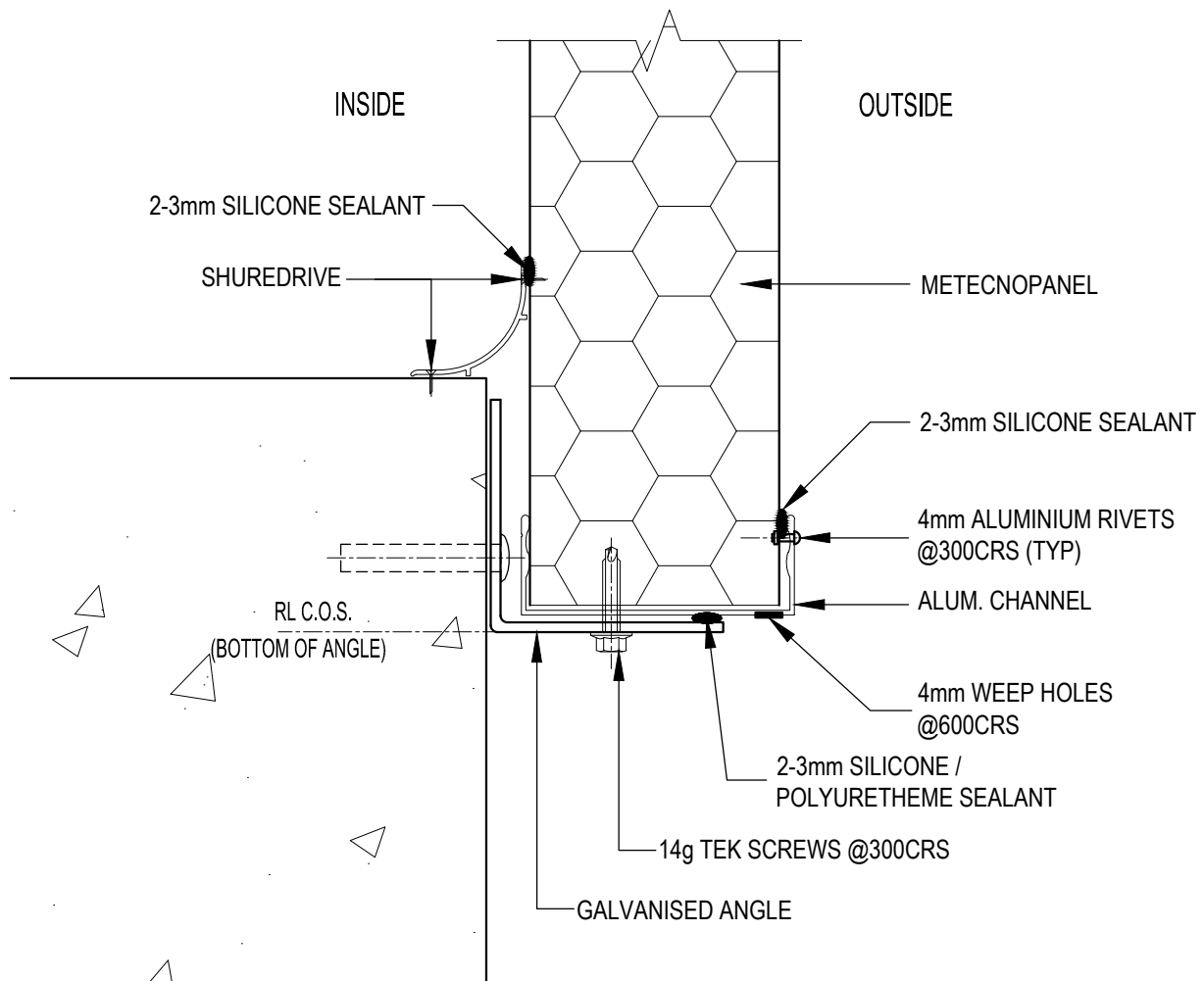

**Note:**

- We recommend that you should engage your local Metecno PIR® architectural specialist at design stage to ensure the panel system is designed to suit specific project requirements.
- All exposed core material is to be encapsulated with a non-combustible covering in order to achieve a BAL-40 or less.
- Panel by Metecno PIR®, screw may be by Metecno PIR®, all other items by others.
- Additional construction details are available through the Metecno PIR Website Client Portal or by contacting a local Metecno PIR® representative. [www.metecnopir.com.au](http://www.metecnopir.com.au)
- This drawing is copyright and the property of Metecno Pty Limited trading as Metecno PIR®. It is subject to their legal recall and may not be reproduced or its contents divulged without written authority.

## External Wall to Sheet Roof Joint - PIR07-OW04-1

### External Vertical Cladding

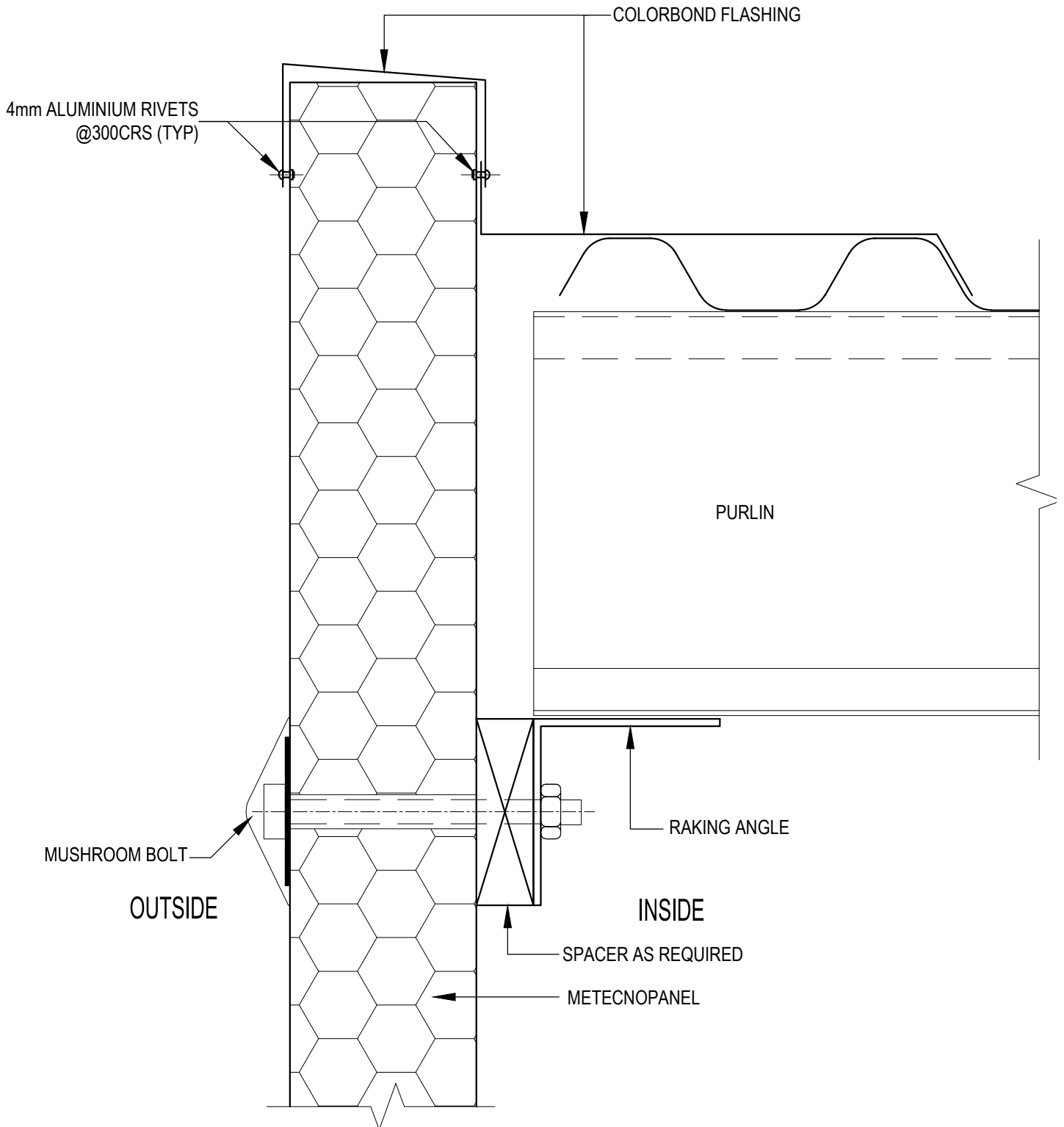

**Note:**

- We recommend that you should engage your local Metecno PIR<sup>®</sup> architectural specialist at design stage to ensure the panel system is designed to suit specific project requirements.
- All exposed core material is to be encapsulated with a non-combustible covering in order to achieve a BAL-40 or less.
- Panel by Metecno PIR<sup>®</sup>, screw may be by Metecno PIR<sup>®</sup>, all other items by others.
- Additional construction details are available through the Metecno PIR Website Client Portal or by contacting a local Metecno PIR<sup>®</sup> representative. [www.metecnopir.com.au](http://www.metecnopir.com.au)
- This drawing is copyright and the property of Metecno Pty Limited trading as Metecno PIR<sup>®</sup>. It is subject to their legal recall and may not be reproduced or its contents divulged without written authority.

## Base Detail - PIR07-WF01-1

### External Cladding

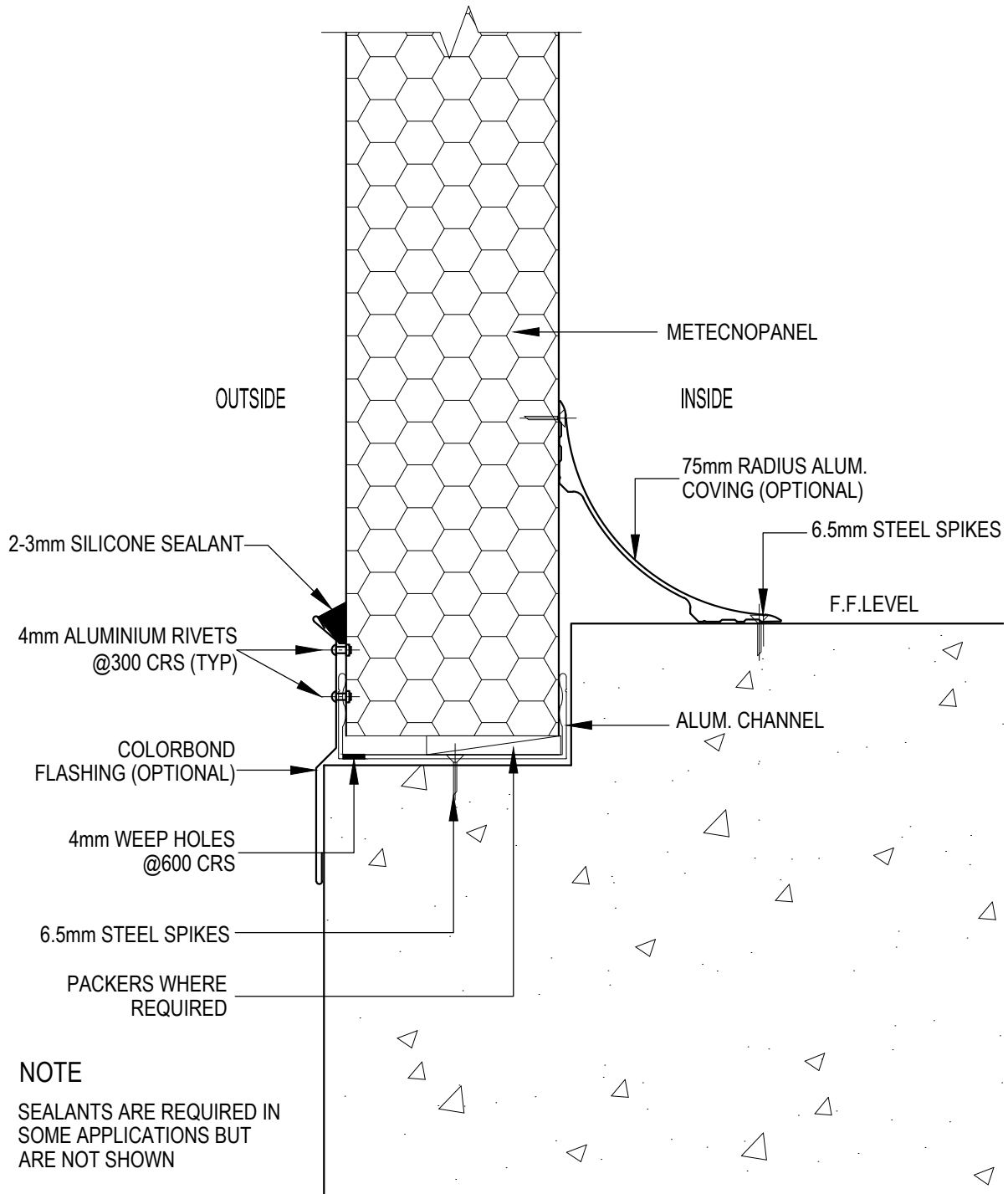

Note:

- We recommend that you should engage your local Metecno PIR<sup>®</sup> architectural specialist at design stage to ensure the panel system is designed to suit specific project requirements.
- All exposed core material is to be encapsulated with a non-combustible covering in order to achieve a BAL-40 or less.
- Panel by Metecno PIR<sup>®</sup>, screw may be by Metecno PIR<sup>®</sup>, all other items by others.
- Additional construction details are available through the Metecno PIR Website Client Portal or by contacting a local Metecno PIR<sup>®</sup> representative. [www.metecnopir.com.au](http://www.metecnopir.com.au)
- This drawing is copyright and the property of Metecno Pty Limited trading as Metecno PIR<sup>®</sup>. It is subject to their legal recall and may not be reproduced or its contents divulged without written authority.



[www.metecnopir.com.au](http://www.metecnopir.com.au)

Call (07) 3323 9900

Metecno Pty Limited. ABN 44 096 402 934. The manufacturer reserves the right to change the specification without notice. Metecno PIR®, MetecnoInfinite®, MetecnoKasset®, MetecnoPanel®, MetecnoSpan® and EconoClad® are trademarks of Metecno Pty Limited. The colours shown in this publication have been reproduced to represent actual product colours as accurately as possible. However, given printing limitations, we recommend checking your chosen colour against an actual sample before placing orders. Panel profiles shown in this publication are indicative only. Refer to engineering for exact specifications. This advice is of a general nature only. Designers must provide for adequate structural performance and other Building Code requirements. This information is subject to change.

\*Warranty subject to exclusions, application and eligibility criteria. For full terms and conditions and to determine the eligibility of your project for the warranty visit [bluescopesteel.com.au/warranties](http://bluescopesteel.com.au/warranties) or call BlueScope on 1800 022 999. Colorbond®, Permagard® and BlueScope are registered trademarks of BlueScope Steel Limited.

Refer to Metecno PIR® website for latest version. Consult Metecno PIR® for your application.

BON0535 Drawing Pack - MetecnoPanel v1. 21/02/19